



Tune-up Kit Install Guide

Thank you for purchasing the [Motor Tune-Up Kit](#) for the Texas Power Paddle Propulsion System. Installation of the kit should take ~15 minutes. There are a few variations of the motor mount for different models so use these pictures as guides as they may not fully depict your specific mount. The only tools you will need are a 2.5 mm and 2.0 mm Allen key, a Phillips screwdriver and the included bearing removal and insert tool.



Removal of the Nose Cone or Motor Mount

- Locate the two 2.5mm Allen screws on the front nose of the motor and unscrew. Remove the nose cone/ motor mount to access the rotor collar set screw.



- Remove the motor duct by unscrewing the four fasteners holding the duct to the motor legs. You can now remove the motor from the duct

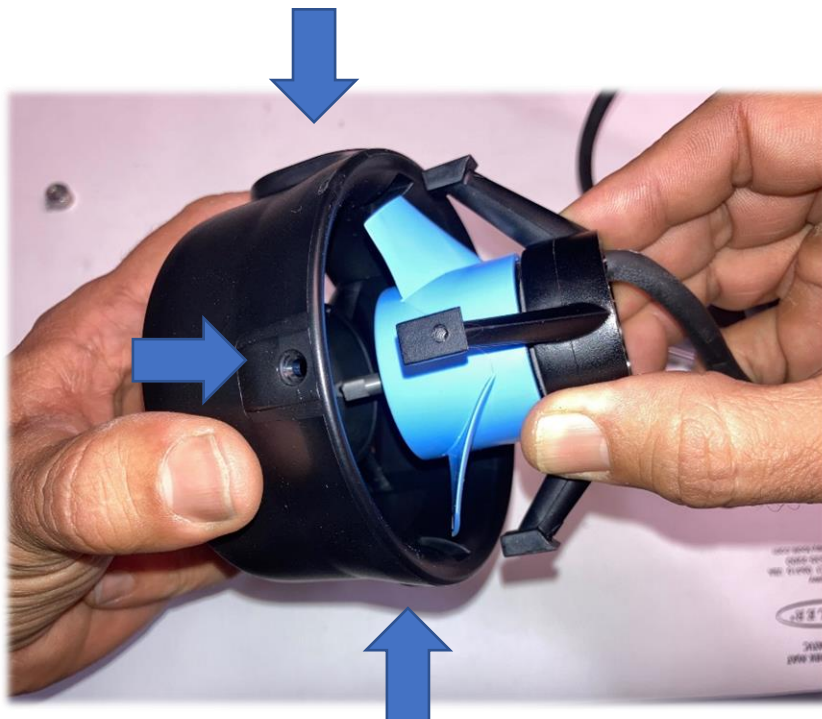

- Remove the rotor collar by using a 2mm Allen key to loosen the set screw and save for reassembly step.

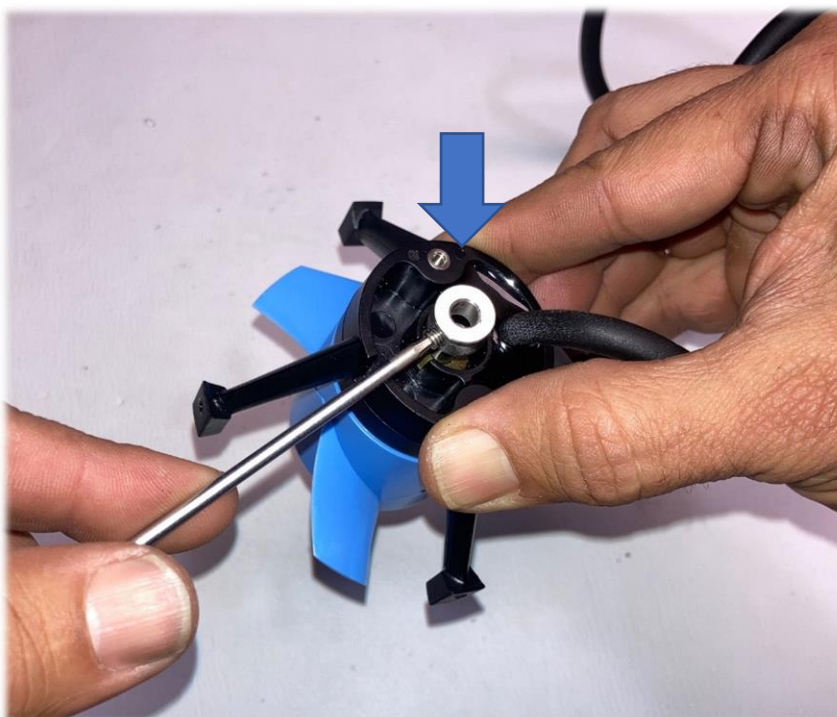

- Remove the impeller and rotor from the sealed motor windings by gently pulling apart.

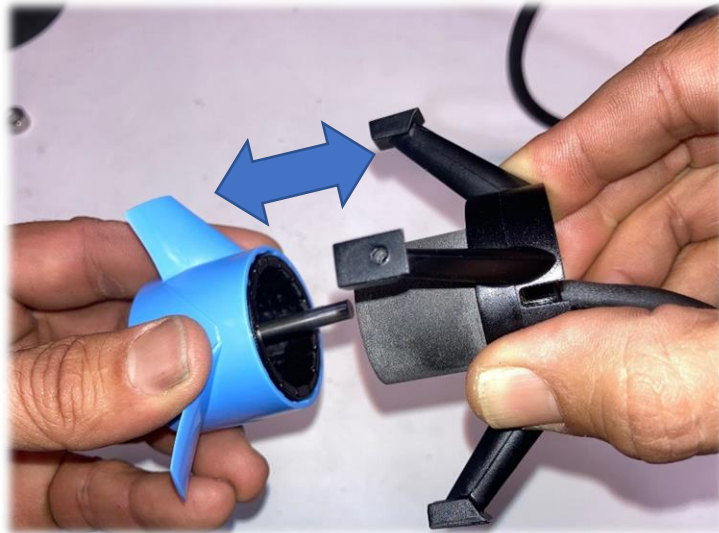

Installation of the Bearings

- Insert the bearing removal tool into each side of the motor and pull outward to remove the bearing. You may need several attempts at removing a worn bearing. In some case you may need to use pliers to assist in removal. The bearing will remain on the tool. Clean the motor shaft where the bearing was previously seated to remove debris.



- Using the opposite side of the tool insert a new bearing over the shaft of the tool and insert into motor and press downward to seat bearing. Repeat for the opposite side of motor. Ensure that bearings are flush with the surface and not protruding.



You can now assemble the new rotor provided with the kit and tighten the rotor collar set screw and reassemble the duct or motor mount. When tightening the set screw make sure shaft is turned to keyed portion to allow set screw to fully seat on shaft. For additional assistance view the following video: